

# Video Security



## CG-532PA1V

1/3" Colour Camera with DSP, AGC, APC  
BLC, ESC, AWB, 230VAC, 540TVL

Art-No. 92494



Lens is not included with the camera

## Features

Resolution of 540 Horizontal Lines  
Automatic Gain Control (AGC)  
High Sensitivity of 0.8Lux (at F1.2)  
Back Light Compensation (BLC)  
Electronic Shutter Control (ESC)  
Automatic AI/DC Control Selection (Depend on Lens)

Horizontal and Vertical Aperture Correction (APC)  
Integrated Eclipse and Flickerless Function  
Automatic White Balance with Hold Function (AWB)  
Auto Blemish Compensation (up to 32 Pixels)  
Adjustable Video Transmission Distance  
Supply Voltage: 230VAC

## Specifications

Video standard	CCIR/PAL
System	Colour
Sensor size	1/3"
Imager	CCD, Sony Super HAD Interline Transfer CCD
Active picture elements	approx. 440,000, 752(H) x 582(V)
Signal processing	Digital (DSP)
Synchronization	Internal/AC line lock
Signal-to-noise ratio	48dB (AGC OFF)
Gamma correction	0.6/1.0
Sensitivity (at 50% video signal)	0,8Lux
Light control range (ESC + AGC)	30,000:1
Light control range (AI + AGC)	600,000:1 (Iris range F1.4 ~ F300)
Electronic shutter control (ESC)	2.000:1 (On/Off switchable)
Integration rate	no
Signal amplification	3 steps (for transmission distance short, middle, long)
Automatic gain control (AGC)	Normal, High and ON/OFF switchable
Backlight compensation	BLC, eclipser, ON/OFF switchable
White balance (AWB)	Auto/Hold

## CG-532PA1V

(Specifications continued)

<b>Blemish compensation</b>	Automatic blemish detection and compensation (for up to 32 pixels)
<b>Aperture Correction (APC)</b>	Horizontal and vertical
<b>Flickerless function</b>	120sec., ON/OFF switchable
<b>Eclipser function</b>	On/Off, Treshold, Eclipse and Grey level
<b>IR cut filter</b>	no
<b>OSD function control</b>	OSD camera setup, Pixel correction, Eclipser, BLC, AWB, Chroma, ESC, AGC, Flickerless, Aperture, Masking (Window blanking), Transmission distance compensation
<b>Lens mount</b>	CS
<b>Usable iris controls</b>	Manual iris, Auto-Iris/DC controlled
<b>Auto-Iris voltage supply</b>	9VDC (40mA max.)
<b>External adjustments</b>	Flange focus Switch for setup menu
<b>Video outputs (type)</b>	CVBS
<b>Video outputs</b>	1Vp-p, composite, 75ohms, BNC
<b>External connections</b>	DC Iris control (4-pin), Video (BNC), Power input
<b>Serial interfaces</b>	no
<b>Camera mount</b>	1/4" - 20 UNC thread on top and bottom
<b>Supply voltage</b>	230VAC
<b>Power consumption</b>	approx. 12watts
<b>Temperature range (Operation)</b>	0 ~ +40°C
<b>Dimensions (HxWxD)</b>	See drawing
<b>Weight</b>	400g
<b>Parts supplied</b>	4-pin plug, Allan key, Manual on CD ROM

## Accessories

<b>70769 / WD-22</b>	Wall Mount Bracket with Ball Joint, 1/4" Camera Fixing Screw, Beige Grey
<b>70771 / WD-23</b>	Wall Mount Bracket with Ball Joint, 1/4" Camera Fixing Screw, Pantone 877
<b>43106 / C/CS RING-AL</b>	Adapter Ring, C/CS Mount, Aluminium anodized

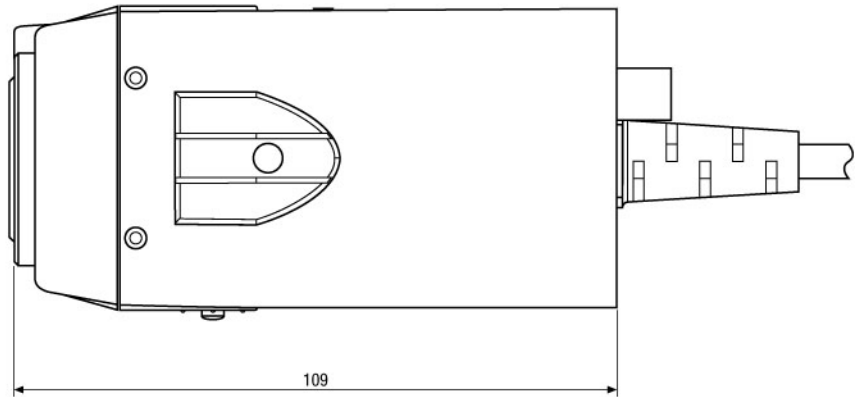
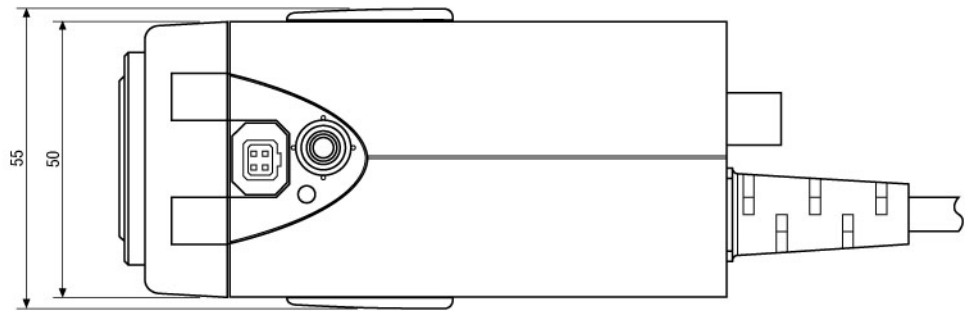
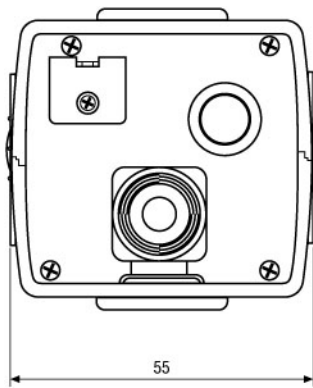

Maße/Dimensions: mm

Sicherheitssysteme Uebachs GmbH  
Your Contact: Fridtjof Uebachs  
Königsallee 22 · 40212 Düsseldorf  
Phone 0211-210744-0 · Fax 0211-210744-29  
technik@uebachs.de · www.uebachs.de

